

Product Showcase 2025



Access To Perfect Texture & Paints



Textures & Paints that protect and perform



Who We Are ?

At Colorvision Paints, we pride ourselves on being a trusted name in the paint industry. Our focus lies in the manufacturing and sale of high-quality paints, offering innovative solutions for both residential and commercial needs.

Our flagship paint brand, Color Tuff Coat and Texture, is designed to meet the diverse requirements of modern construction and design. Whether it's for enhancing the aesthetics of interiors or providing durable protection for exteriors, our products deliver unmatched performance. Color Tuff Coat ensures a long-lasting and flawless finish, while our Texture line adds a touch of uniqueness and elegance to walls with its vibrant designs and patterns.

Why Colorvision Paints ?



Full Customer Support

We provide end-to-end assistance, from product selection to application guidance, ensuring a seamless experience for our customers.



Excellent Quality

Our paints and textures are crafted with premium-grade materials, offering long-lasting durability, vibrant finishes, and superior coverage.



In-House Production

All our products are manufactured in our state-of-the-art factory, ensuring strict quality control and innovative formulations.



Our Products



COLOR TUFF COAT TEXTURE

- very smooth Surfaces
- synthetic grooved finish Texture.



COLOR TUFF COAT PAINT

- Standard Medium Rough Surfaces Used
- for decoration and long term protection

Application Data

Packaging



30 kg Drum/Bag Self Life

12 months in Drum & 6 months in Bag in original sealed pack from the date of mfg.



APPLICATION DATA



Thinner/ Cleaner
Fresh Tap Water



Thinning Recommended
Dilute approx. 3% if required
for better consistency

Overcoating time
(at 25 ± 2° C)
12 - 16 hrs

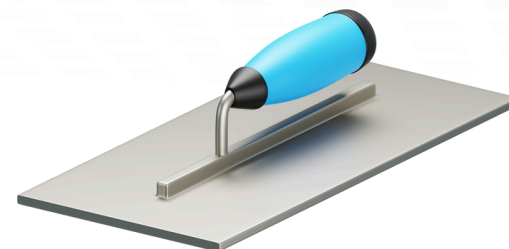

Application Method
Trowel

Directions For Use

Primer Application

Normally primer is not recommended on new surfaces. However in case of chalky substrate or repainting, it is recommended to apply one coat of Extrenal base primer.

Texture Application

Apply one coat of Color Tuff Coat - Scratch with trowel and allow it to dry for 16-18 hrs.

Recommended Tool

Steel & Plastic Trowel.

Overcoating time

(at 25 ± 2° C)

12 - 16 hrs.



Safety & Precautions

- Prior to use, read and follow product specification, MSDS and label information.
- Stir the contents thoroughly before dilution, avoid extra thinning, over extend the roller/brush.
- Do not apply when temperature is below 10°C, humidity above 90%.
- Ensure that existing paint is properly bonded and, not peeling off.

- Avoid contact with eyes and skin. • Use safety equipments like rubber or polythene gloves, safety goggle / glasses and face mask.
- Keep away from children.
- Stir / Mix Well before use
- Moisture content of the wall should be ideally below 12%
- pHvalue of the wall surface should be ideally between 7-11.

Recommended System

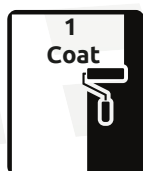

Protection
Paint

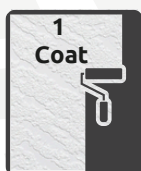

Color Tuff
Coat Scratch



Shipping Information



Freight
Classification Paint



Flammability Non-
Flammable Flash
Point - Water

COLOR TUFF COAT

TEXTURED EXTERIOR WALL FINISH

SCRATCH

PRODUCT DESCRIPTION

Color Tuff Coat Scratch is a popular & preferred trowel applied synthetic grooved finish Texture. The product is formulated with modified acrylic emulsion and reinforced with quartz aggregates to withstand humidity, rain and variable climates. Used for decoration and long term protection. It is highly recommended for freshly plastered surfaces and also ideal for reviving old weather beaten surfaces.

Color Tuff Coat -Scratch is now offered in different variants based on the groove pattern:

- Fine (0.8 to 1 mm) : recommended for very smooth Surfaces
- Regular (1.2 to 1.5 mm) : recommended for smooth Surfaces
- Standard (2 to 2.5 mm) : recommended for Medium Rough Surfaces
- High Build (3 mm +) : recommended for Rough Surfaces



Recommended Usage Area:

- Cement Plaster, RCC Work.
- For Exterior use.

TECHNICAL DATA

Colour: Off White **Drying Time**

(at 25 ± 2 °C, Relative Humidity 60%)

• Touch dry (hrs.): ½ hr.

• Dry to recoat: 12 ~ 16 hrs.

(Drying time may vary as per temperature, film thickness, humidity etc.)

• **Gloss Level:** Matt when released

• **Pot Life of Thinned Material:** 2-3 hours

• **Density:** 1.95 ± 0.5

• **VOC:** Less than 52.7 gm/ltr

• **Flash Point:** NA



Theoretical Coverage*

- Fine (0.5 mm to 1 mm) - 3.5 ~ 4.5 Sq. ft. / Kg/ Coat
- Regular (1 mm to 1.5 mm) - 2.5 ~ 3.0 Sq. Ft./Kg/Coat
- Standard (1.5 mm to 2 mm) - 2.0 ~ 2.5 Sq.Ft./Kg/Coat
- High Build (2 mm to 3 mm) - 1.6 ~ 2.0 Sq.Ft./Kg/Coat

* It depends on many factors like surface condition, surface roughness & porosity, surface preparation, application skill, weather conditions, dilution etc. The coverage mentioned is under ideal conditions and will vary depending on the site condition. It is recommended to establish coverage on actual site.

SURFACE PREPARATION

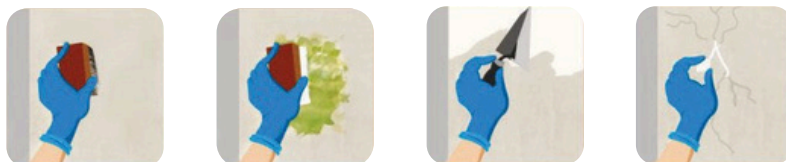

• **Surface Inspection** - Before painting the exterior walls, undertake repairs of all surface imperfections - cracks, leakages, undulations and rust - caused by drainage pipes. • **Scraping & Cleaning** - Remove all loose paint, dirt, fungus, algae, moss and salt deposits alternatively by wire brushing the surface. On the fungus affected areas, apply 1 Coat of External base primer Bio-Wash solution (5% /v) by brush. Allow it to dry overnight. Wash it again next day with potable water thoroughly. Wash the scraped surface thoroughly and allow it to dry. Color Vision Recommended Tools _ Express Painting Sander with Paint Scraper attachment and Express Painting Jet Washer.

PROJECTS



Minarva Lokhandwala



Sandeep Kedardham Building



Piramal Aranya, Byculla

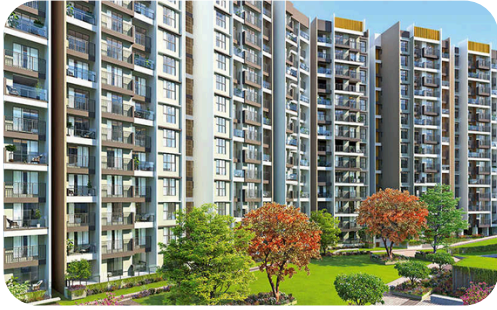

L&T Seawoods Residences



Oberoi Sky City Borivali



Lodha Palava

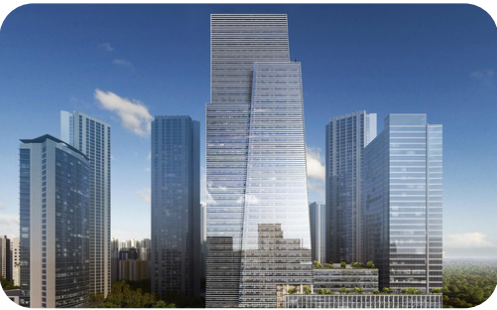

Oberoi Commerz III



Oberoi Eternia



Pbel City Hyderabad



Piramal Mahalaxmi



The Regent Tower, Hyderabad



Vue Residences, Hyderabad



Rustomjee La Familia, Thane



Runwal Garden City, Thane



Imperial Edge Mumbai



PROJECTS



Lodha Seamont



Lodha Cuff Parade

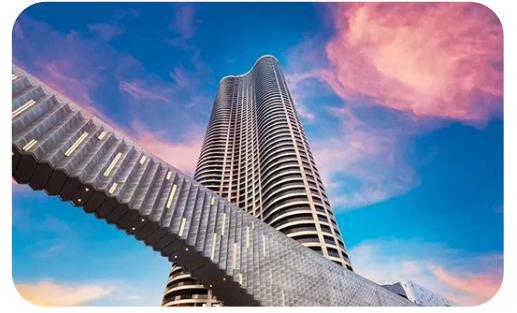

Lodha World Tower



Lodha Anjur



Lodha The Park



Runwal The Orchard Residency



Mahindra Happiness Pune



Wadhwa The Address, Ghatkopar



Omkar Alta Monte, Malad



VTP Pegasus, Pune



Kohinoor, Hyderabad



Balaji International School, Kalamboli



Godrej Green Park, Pune

OUR CLIENTS

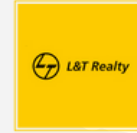

COLOR VISION PAINTS

Office No - 03 Sawan Heritage Plot No 20&21 SEC-15 Kalamboli Navi
Mumbai 410218

Customer Care No.: +91 8655728476

Email: sales@colorvisionservices.in

